

With a spacious front porch and cool windows, this plan sports inviting curb appeal.



©www.ePlans.com

# HOUSE OF THE WEEK

## Bright and Open Craftsman Design



**CALL DAVE HOBBA BUILDER!**  
 (304) 937 - 2090  
 DAVEHOBBA BUILDER.COM

**489 CRYSTAL SPRINGS DRIVE, WINFIELD**  
 Amazing lot cleared and ready to build! 1.61 acres  
**\$55k**

**SADDLE CREEK PLANTATION, MILTON**  
 Spacious lots with great views! 1 acre to 6 acre lots  
**\$48k - \$68k**

**MANDY DR., COBBLESTONE SCOTT DEPOT**  
 Amazing Lot! 1.45 acres  
**\$79,500**

**HIGHLAND MEADOWS, BARBOURSVILLE**  
 Secluded and lots with amazing views available 1 acre to 4 acre  
**\$40k - \$80k**

**COURTYARD ESTATES, WINFIELD**  
 Flat Spacious lots!  
**\$49k - \$58k**

**DOUBLE EAGLE, CHARLESTON**  
 Bordering Berry Hills Golf Course and Country Club GW School District 1/3 acre to 3 acre lots  
**\$47k - \$104k**

**STIRLING COURT, SOUTH HILLS CHARLESTON**  
 GW School District  
 Lots starting at \$129k



**Luxury Living Realty**  
 Dave Hobba, Broker/Builder (304) 545-6838  
 Cheryl Hobba, New Home Specialist/  
 Realtor (304) 546-5348

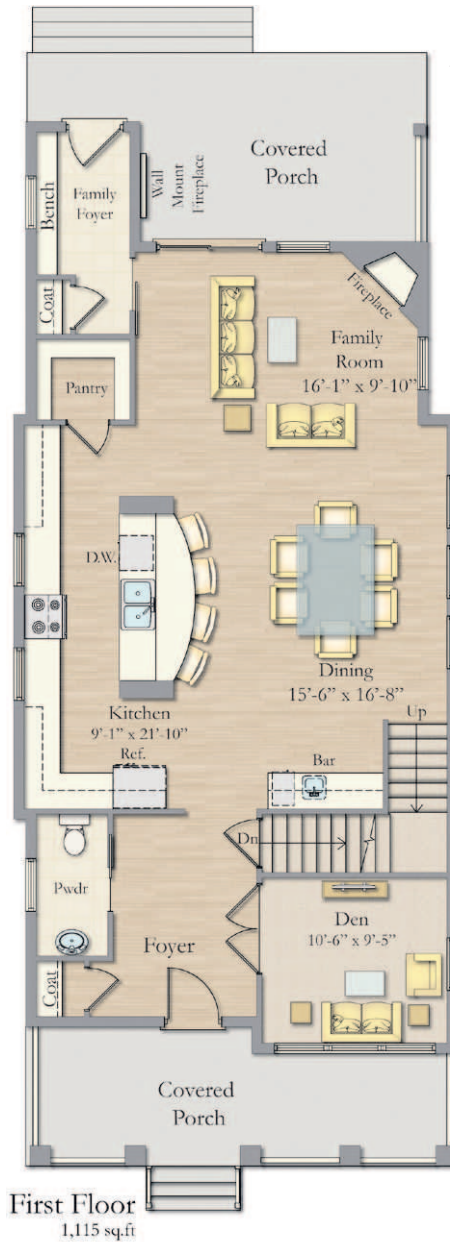

First Floor  
1,115 sq.ft



Second Floor  
1,275 sq.ft

There's no shortage of curb appeal for this stunning Craftsman design! This design offers relaxed living and plenty of thoughtful touches. The contemporary open layout flows from the great room to the island kitchen and into the casual dining area. A walk-in pantry makes it easy to keep groceries organized, while a family foyer keeps things tidy with a coat closet and handy bench. Other highlights we love include the covered rear porch, large master suite, flexible den, and the convenient laundry located on the second level.

- Save 10% on your house plans (some exclusions apply) with coupon code: NEWSPAPER.

— Courtesy of www.ePlans.com

**Design details for plan 1057-11**

- Bedrooms: 4
- Baths: 2.5
- Total Living Area: 2,430 sq. ft.
- Dimensions: 25' x 59' 4"
- Framing: 2 x 6

**ORDER INFORMATION**

To build this home, you can order a complete set of construction documents by calling toll-free (866) 228-0193 or visiting <https://www.eplans.com/collection/house-of-the-week>. Enter the design number to locate the plan and view more images and details. At <https://www.eplans.com/collection/house-of-the-week>, you can view previously featured plans, browse other specialty collections, or use our search filters to help you find exactly what you want from over 28,000 home designs. Most plans can be customized to suit your lifestyle.

A super open layout between the island kitchen, large great room, and dining area provides a seamless flow.

See images of the plan online at [www.eplans.com/collection/house-of-the-week](http://www.eplans.com/collection/house-of-the-week)



**If you can DREAM it, We can BUILD it**

Check us out on Facebook or visit [DaveHobbaBuilder.com](http://DaveHobbaBuilder.com)

**We Can Build This Home For You!**



Contact our DHB Design Center (304) 937-2090

*"Working with DHB was a wonderful experience. We would recommend them to anyone looking to build a home."*  
 Jason & Mary Alice

